

Pane=(W-151)
 MK-- 629
 SK-- 791
 PK-- 989
 UK-- 1189

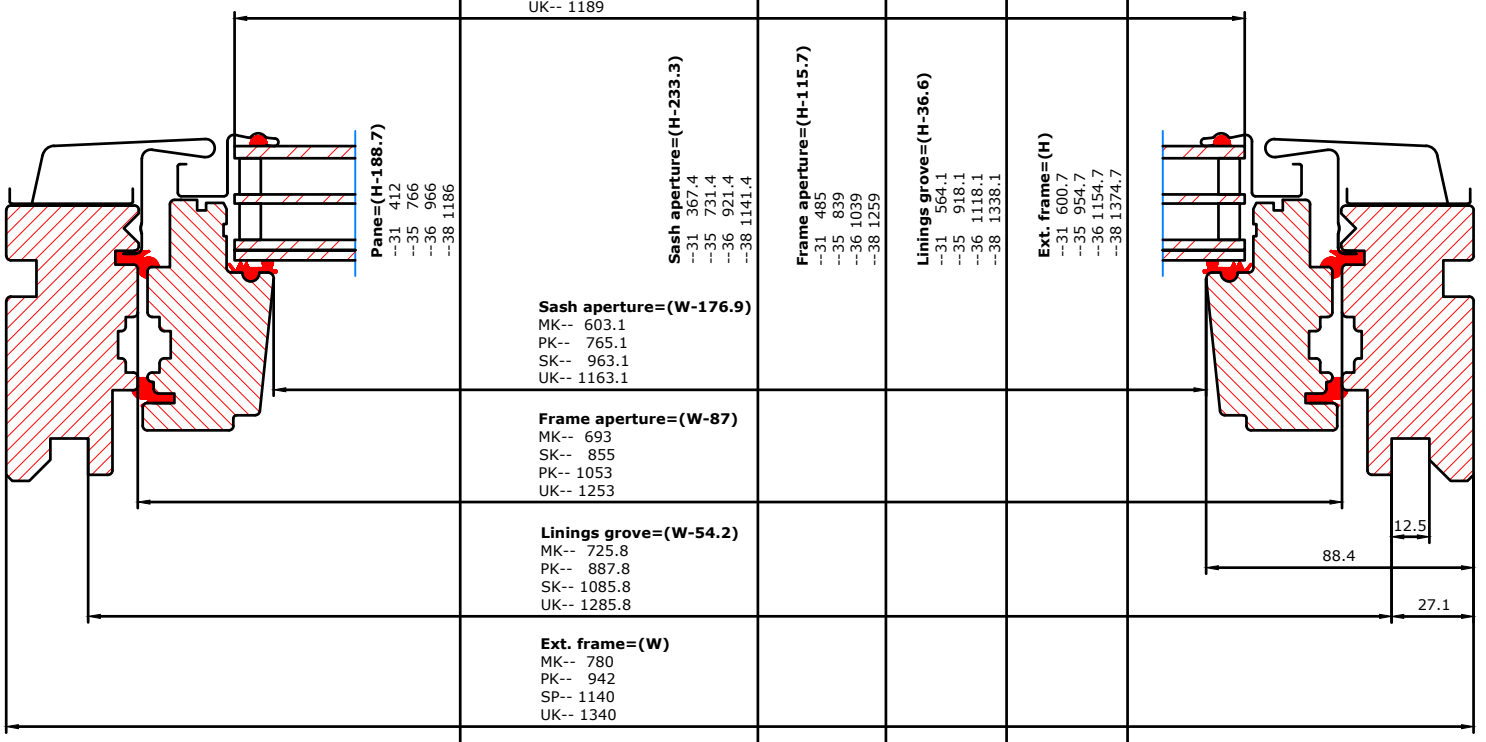

Pane=(H-188.7)
 --31 412
 --35 766
 --36 966
 --38 1186

Sash aperture=(H-233.3)
 --31 367.4
 --35 731.4
 --36 921.4
 --38 1141.4

Frame aperture=(H-115.7)
 --31 485
 --35 839
 --36 1039
 --38 1259

Linings groove=(H-36.6)
 --31 564.1
 --35 918.1
 --36 1118.1
 --38 1338.1

Ext. frame=(H)
 --31 600.7
 --35 954.7
 --36 1154.7
 --38 1374.7

Sash aperture=(W-176.9)
 MK-- 603.1
 PK-- 765.1
 SK-- 963.1
 UK-- 1163.1

Frame aperture=(W-87)
 MK-- 693
 SK-- 855
 PK-- 1053
 UK-- 1253

Linings groove=(W-54.2)
 MK-- 725.8
 PK-- 887.8
 SK-- 1085.8
 UK-- 1285.8

Ext. frame=(W)
 MK-- 780
 PK-- 942
 SP-- 1140
 UK-- 1340

12.5
 88.4
 27.1

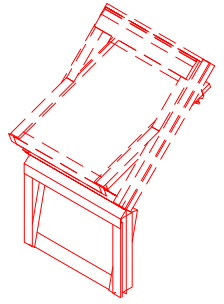
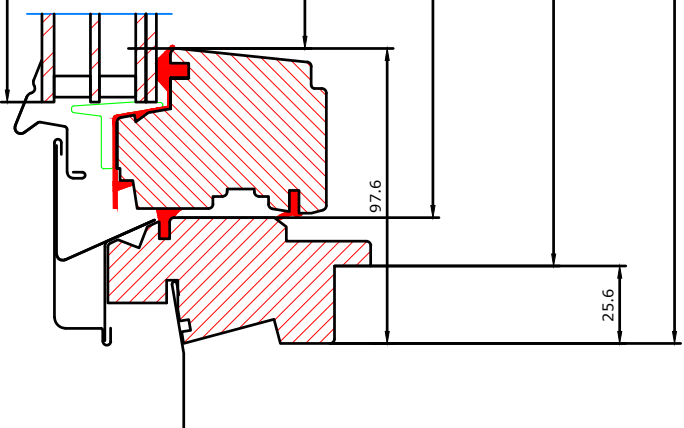

VELUX

VFE --66

19.10.2015/EMB

